

January 2000

Suggested Agriculture Education Facilities

Facility	Size (in sq. ft.)	Ag Mechanics	Animal Science	Agri- business	Horti- culture	Agri- science	Forestry
Classroom	950 - 1200	X	X	X	X	X	X
Office	150	X	X	X	X	X	X
Forestry Plot	5 acre minimum						X
Tool/Equipment Storage	200 – 400	X	X		X	X	X
Supply Storage	200 – 400	X	X	X	X	X	X
Project Storage	200 - 400	X	X		X	X	X
Outdoor Covered Work Area	800	X	X		X	X	X
Chemical Storage	20 cu. ft.	X	X		X	X	X
Wash Room Bathroom	150	X	X		X	X	X
Fenced Plot	1000		X		X	X	
Greenhouse	1800				X	X	
Work Room	950		X		X	X	X
Agriscience Lab	950					X	
Cold Frame	768 (16x48)				X		
Shade House or Nursery	300				X		
Ag Mechanics Lab	2800 - 3500	X					
Aquaculture Lab	200		X			X	
Animal Science Lab*	1000		X				

Classroom: A classroom should be provided for each teacher. If two agriculture classrooms are to be included, a soundproof folding or sliding divider may be considered to separate the rooms. This will allow the divider to be opened to provide a larger meeting space for FFA meeting, community meetings, large class instruction, etc.

The classroom may be combined with the agriscience or other clean laboratory facilities. The classroom should not be part of the agricultural mechanics laboratory or greenhouse. In many instances, a large combination facility with an unobstructed view from all points in the room is desirable. A sink/clean-up area should be located in the greenhouse. If the greenhouse is to be attached to the building, the greenhouse must be located facing south and receive full sunlight, unobstructed by shadows from the buildings, tress, etc.

Because of the nature of agriculture instruction, tables and chairs are recommended for the classroom rather than desks or other student seating. The tables should be movable to allow various arrangements for instructional purposes.

Other items to include in the classroom include:

Internet access	Bulletin boards
Chalkboards	Computer workstations
Teacher demonstration area	Overhead storage on walls
Magazine rack	Student notebook storage rack
Bookcases	Projection screen
TV monitor	Projection unit, ceiling mounted
Podium	Teacher desk
File cabinets	

Office: One hundred fifty square feet of office space should be provided for one teacher and an additional fifty square feet for each additional teacher if office space is to be shared. Glass paneling should be used to allow full view of the classroom and laboratory area from the office. Telephone and Internet service must be provided. A restroom near the office is recommended.

Greenhouse: The greenhouse should be constructed according to commercial specifications. A commercial greenhouse to design, locate and erect the greenhouse is highly recommended. The greenhouse should contain crossbenching to facilitate teaching and student access. The greenhouse should be located so that it receives full sunlight during winter. Aisles must be wide enough to accommodate handicapped students.

Workroom: The workroom described here can serve many purposes from potting of horticultural crops to small engine repair. The room should be a general-purpose workroom with bench space to accommodate a full class.

Handicap Accessibility: All areas of the agriculture facility must be handicap accessible.

***The Animal Science lab:** The animal science lab should be a minimum of 1000 square feet of covered shelter area, ideally located on school property or in close proximity. It should be equipped with animal penning and portable livestock panels, and have storage space for items such as scales. A facility such as a county livestock lab may substitute if it is close enough for convenient use and the teacher and students have access at all times. These are minimum recommendations.

Safety: The facility must be equipped with all required safety items. Each area should include a safety shower. A hazardous material vent hood should be included in the Agriscience lab and in other labs if hazardous materials are to be used.

Other Considerations: Piped, compressed air should be available in all areas.

Georgia Agriculture Education Classroom & Lab Facility

Livestock Facility
Nursery Shade House
Pond

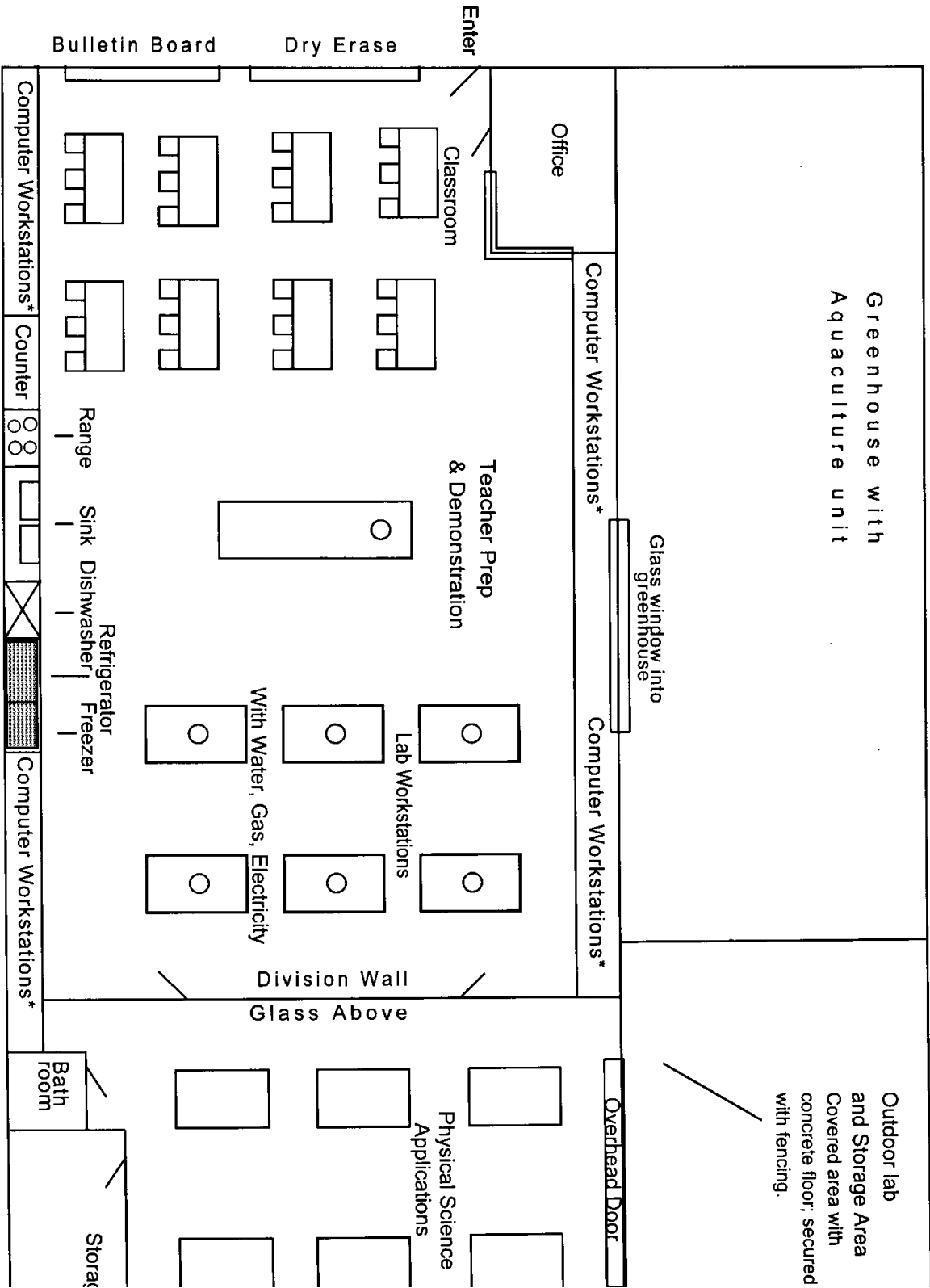

Food Science Prep Area
* Storage above and below *
Original Scale 1" = 10'
Total size excluding Outdoor Lab and Greenhouse = 3600 sq. ft.